

# REVERSIBLE BACKSTAY INSTALLATION GUIDE -SWEEP-

TORQUE TO  
12-15 FT-LBS. (16-20 NM)  
DO NOT OVER TIGHTEN

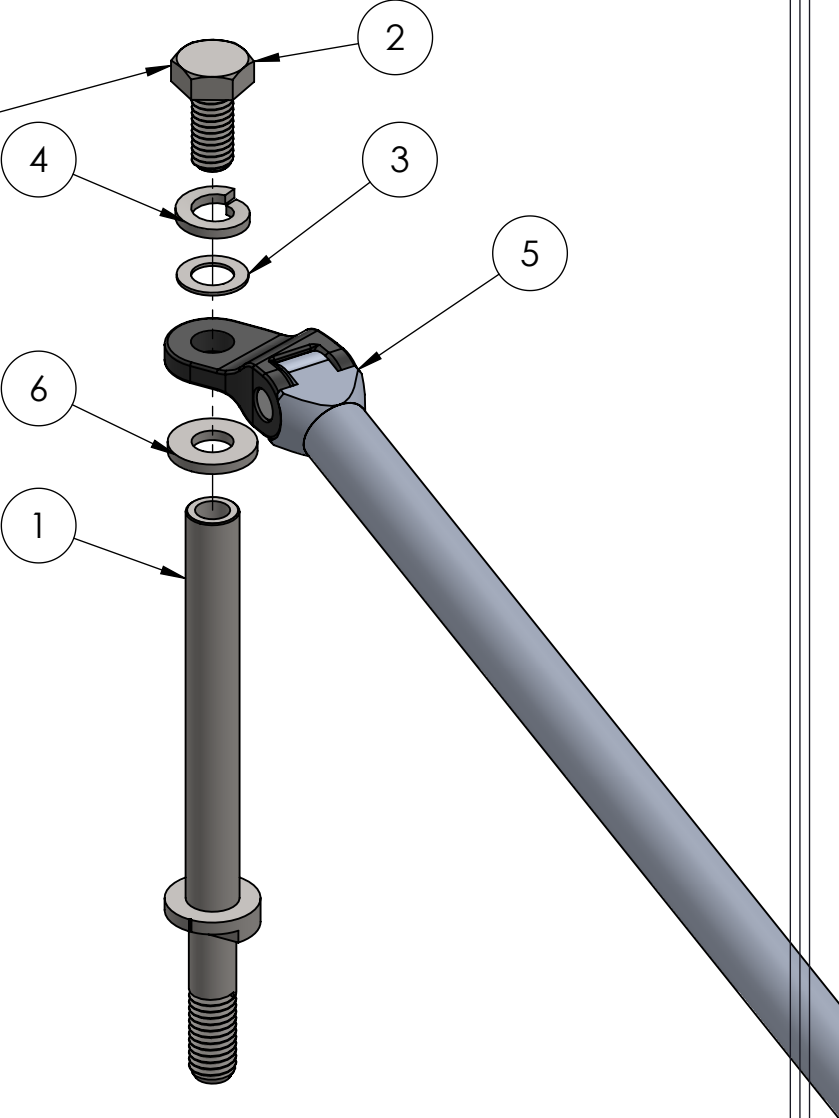

ITEM NO.	PART NUMBER	DESCRIPTION	QTY.
1	ESR02.01	9/16" SWEEP PIN	1
2	RR05.02	TOP BOLT	1
3	RR05.01F	FLAT WASHER	1
4	RR05.01L	SPLIT LOCK WASHER	1
5	RB02.XXY	REVERSIBLE BACKSTAY	1
6	RR05.01B	OVERSIZED WASHER	1

**VESPOLI**

385 Clinton Ave.  
New Haven, CT 06513

Scale: 1:2

Drawn by: VC

Date: 5/22/2019

Part No.

**RB02.XXY**

Sheet: 1 of 1

Sheet Size: A

Description:

**REVERSIBLE BACKSTAY & PIN ASSEMBLY (SWEEP)**

Rev.

Material:

**N/A**

Finish:

**N/A**

**B**