

NOTES:

1. USED ON 2-/X AND 4-/X BOATS WITH FLAT FINs (1/4" DIAMETER SHAFTS WITH 3/16" WIDE RECTANGULAR KEYS)
2. CAN REPLACE OLD YOKES W/ SAME SHAFT DIMENSIONS
3. SOLD FULLY ASSEMBLED

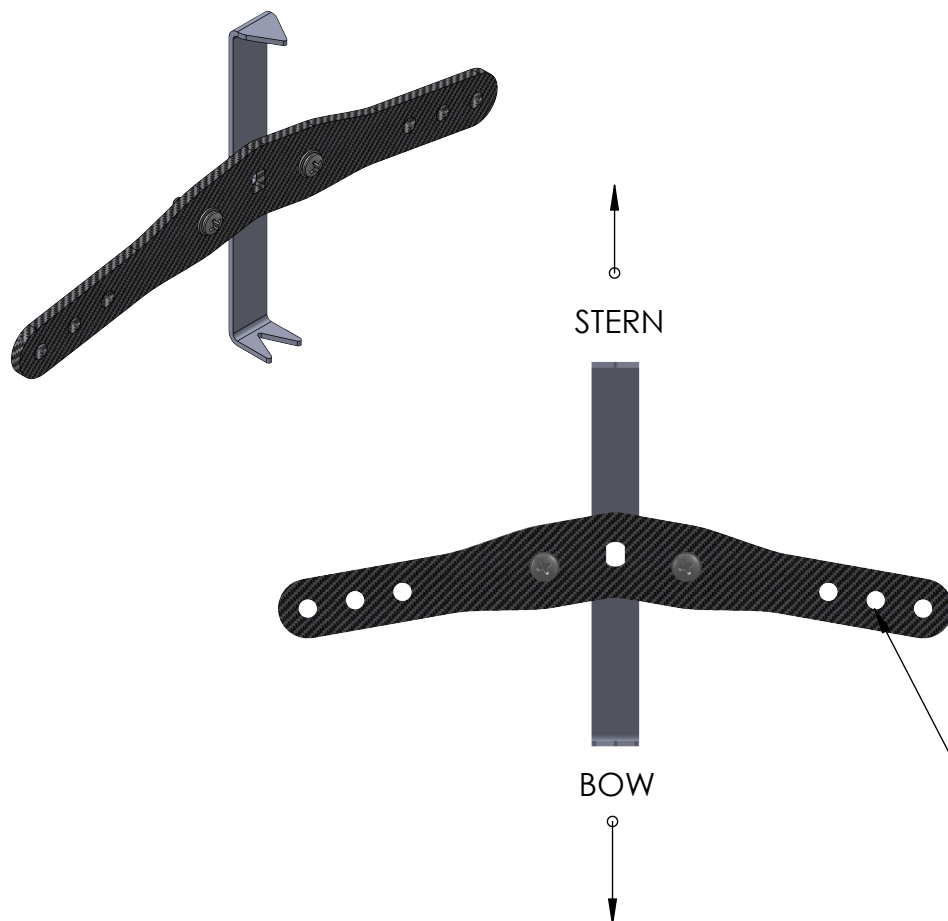

REVISION TABLE				
REV.	DESCRIPTION	DATE	ENGINEER	APPROVED
A	Released for Mfg.	9/27/19	VC	VC
B	FR22.07S Replaces FR22.04S	6/25/2025	VC	DT

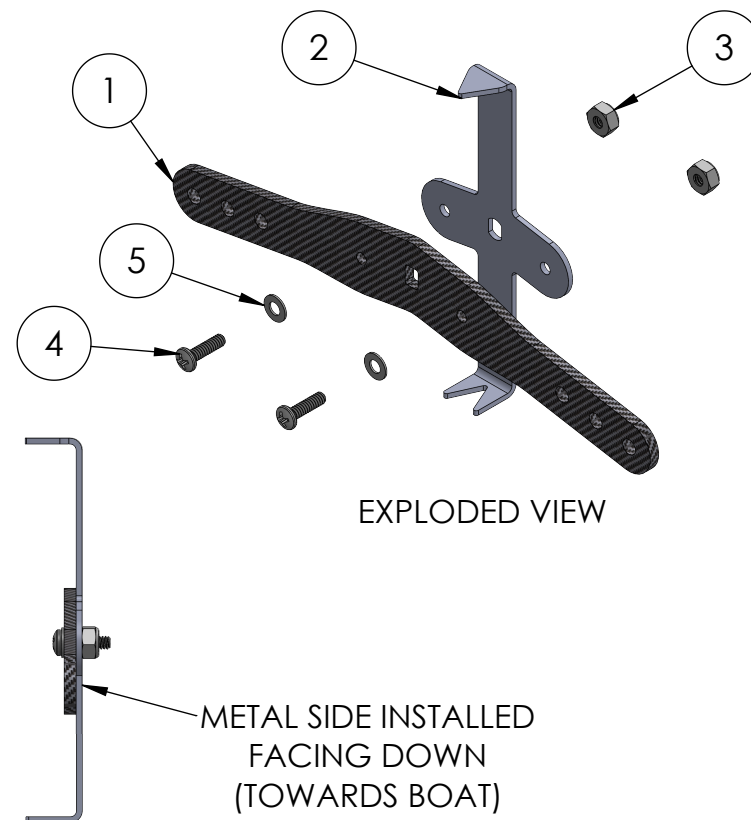

STEERING CABLE CAN BE MOVE IN OR OUT FOR MORE (IN) OR LESS (OUT) SENSITIVITY

ITEM NO.	PART NUMBER	DESCRIPTION	QTY.
1	FR22.06C	CARBON 2-/4- YOKE FOR BOATS WITH 1/4" RUDDER SHAFTS	1
2	FR22.07S	STAINLESS POINTER/INSERT	1
3	HWN.0006	6-32 NYLOCK NUT, SS	2
4	HWS.0015	6-32 x .5" SCREW, SS	2
5	HWW.0015	#6 FLAT WASHER, SS	2

Tolerances Unless Otherwise Specified (in)				
x	xx	xxx	≤	x/x
±.050	±.015	±.005	±1°	±.063

VESPOLI		385 Clinton Ave. New Haven, CT 06513	
Scale: 1:2	Drawn by: VC	Date: 6/2/2025	
Revised by:	Approved by:	Date:	
Part No. FR22.10Y	Sheet: 1 of 1		Sheet Size: A
Description: CARBON/STAINLESS YOKE ASSEMBLY (FOR 2-/4- WITH FLAT FINs)	Rev. B		
Material: N/A	Finish: N/A		